

COTTON CANDY INSTRUCTIONS



OPERATING INSTRUCTIONS

1. Place machine on a flat, stable surface
2. Loosen and drop down side bolts
3. Place floss pan over top of the spinner head
4. Place the pink shield onto the floss pan
5. Plug the floss machine into an electrical outlet
6. With main switch still OFF, fill the floss head 90% full with sugar - **DO NOT OVERFILL**
7. Before turning the power on, manually turn the head to balance out the sugar level - **NEVER ADD SUGAR WHILE MOTOR IS RUNNING**
7. Turn the main switch to ON & turn heat control knob clockwise to maximum setting to initiate a quick warm up
8. Machine will begin making floss within a few seconds, reduce the heat setting when floss begins to form; reduce heat if smoking occurs



SHUT DOWN PROCEDURE

Run all the sugar out of the floss head then turn the heat to highest setting for approximately 1 minute to bake off any remaining sugar
NEVER PUT WATER IN THE FLOSS HEAD

HOW TO MAKE FLOSS

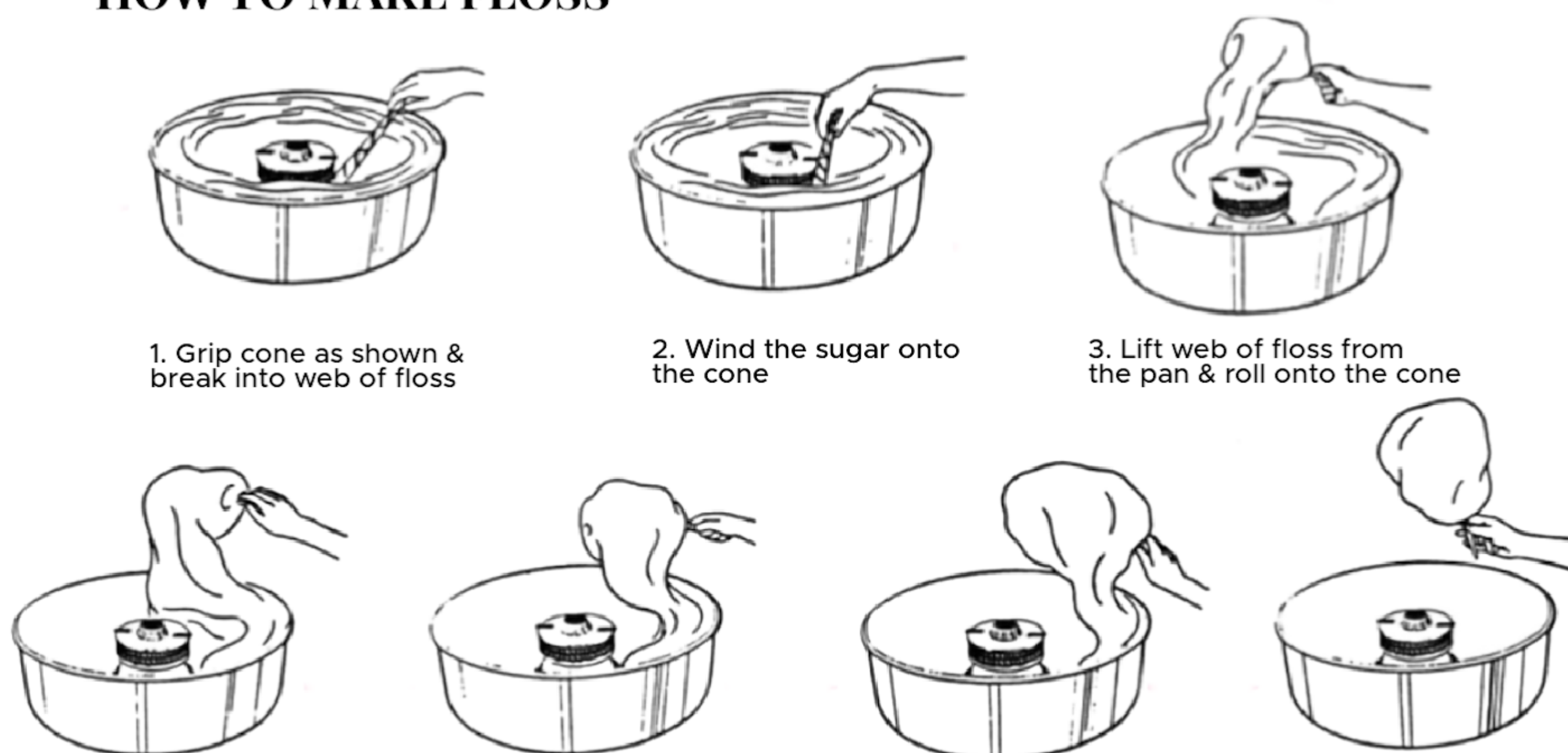

DO NOT PUT HANDS OR OBJECTS IN ROTATING SPINNER HEAD

DO NOT FILL SPINNER HEAD WITH SUGAR WHILE IT IS ROTATING

ALWAYS REDUCE HEAT SETTING WHEN YOU SMELL SMOKE OR BURNING

CLEANING PROCEDURE

1. Unplug the electrical cord
2. Remove shield; wash with soap & water, then dry
3. Remove floss pan, wash with soap & water, then dry
4. Wipe floss head with damp cloth
5. Tighten the side bolts for transport
6. Be sure all parts are dry before resuming operation